

Complete shotcrete lance in carry-case for X-PRO machine - Case



Détails des pièces

Pos.	Référence	Désignation
1	1032155	Empty carry case for TURBO T25
2	20145	Single shotcrete lance for X-PRO machine
3	20170	ø 30 mm shotcrete nozzle
4	11752	Worm gear clamp 50 x 70 x 9
5	20049	Cleaning ball ø 60
6	MI3M07300102	Air injector tube brush

Complete shotcrete lance in carry-case for X-PRO machine - Lance

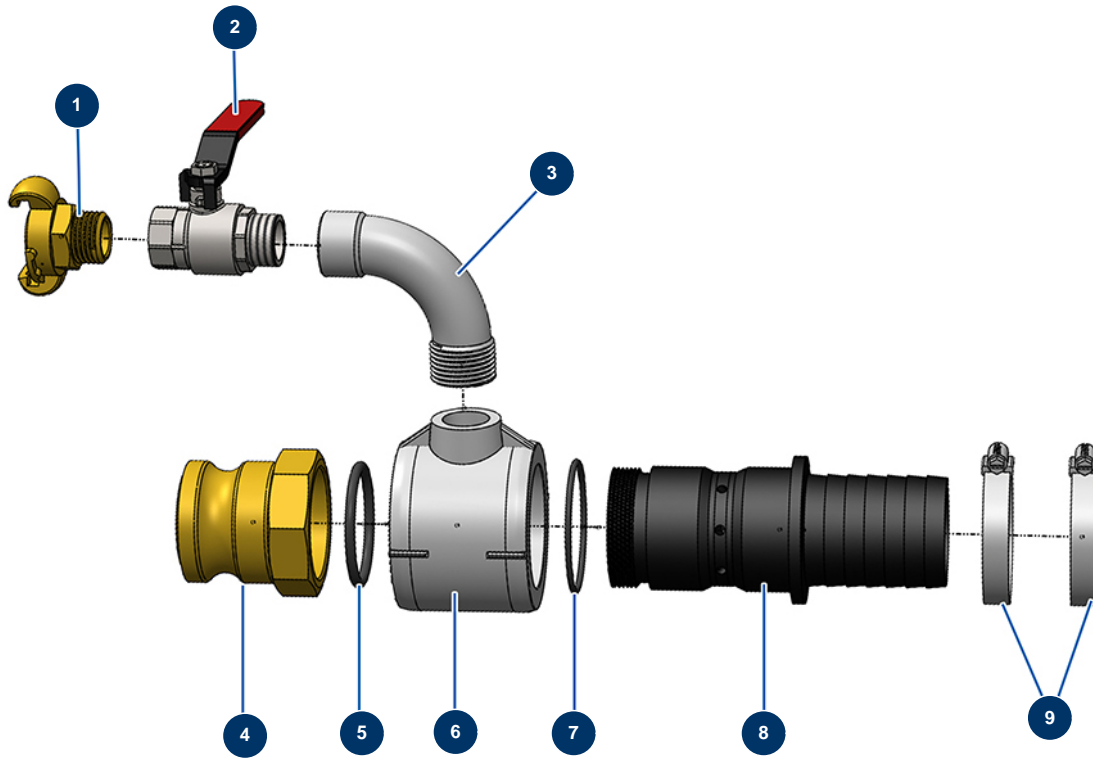

Détails des pièces

Pos.	Référence	Désignation
1	20072	
2	90012	Red handle valve M3/4" x F3/4"
3	20153	
4	12365	2" steel adapter, inner threaded 2"
5	20642	O-ring 55 x 5 for shotcrete lance head
6	20063	
7	20264	O-ring 63x3 for shotcrete lance head
8	20215	
9	11752	Worm gear clamp 50 x 70 x 9