

X-SCREED D60 dry screed machine - stage V 42kW - Air system

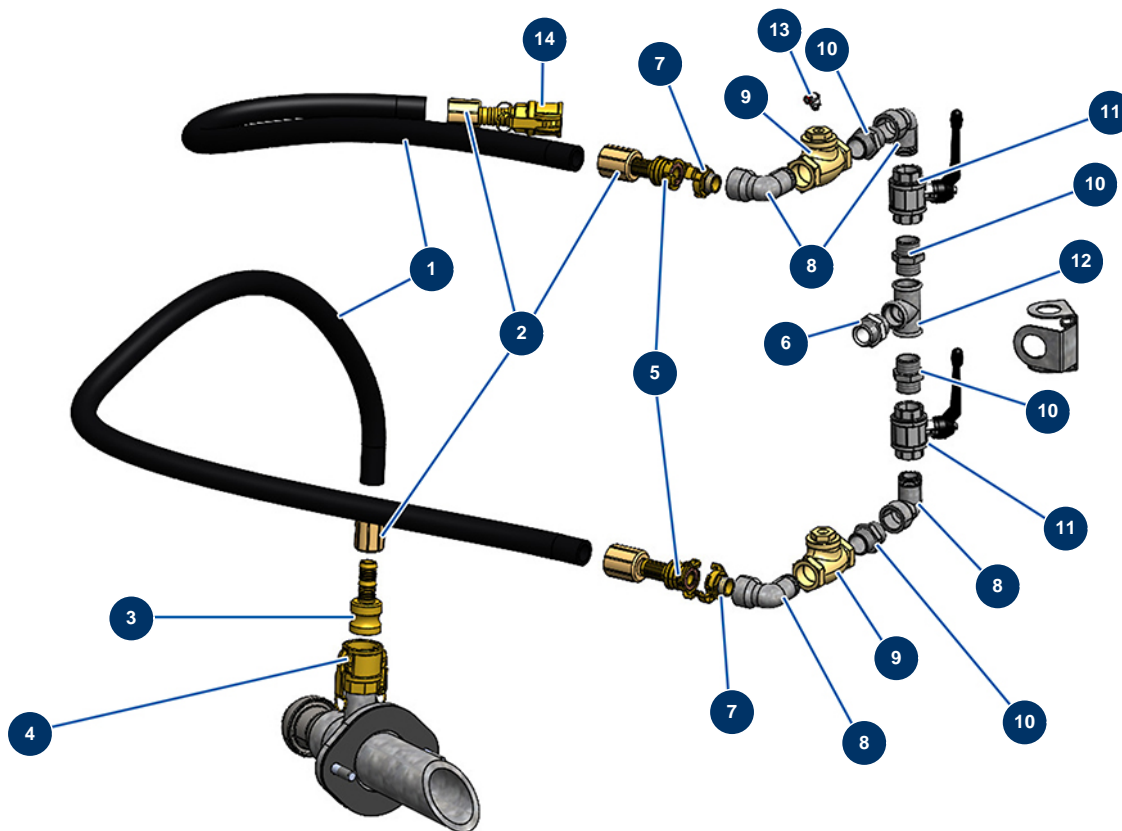

Détails des pièces

Pos.	Référence	Désignation
1	10268	Spray hose 25 x 37 by the metre
2	12434	2
3	12517	1"1/4 steel adapter, corrugated ø 25
4	12376	1"1/4 camlock steel coupling, inner threaded 1"1/2 - CP 60
5	MI3A00100125	5
6	20574	6
7	13574	1" GEKA outer threaded coupling
8	12870	Elbow BP 90° 1" MaleC x 1" FemaleD
9	20338	PTFE 1" non-return valve
10	20335	
11	20261	
12	20336	
13	20395	13

Pos.	Référence	Désignation
14	12433	14