

X-SCREED D60 dry screed machine - stage V 42kW - Chassis

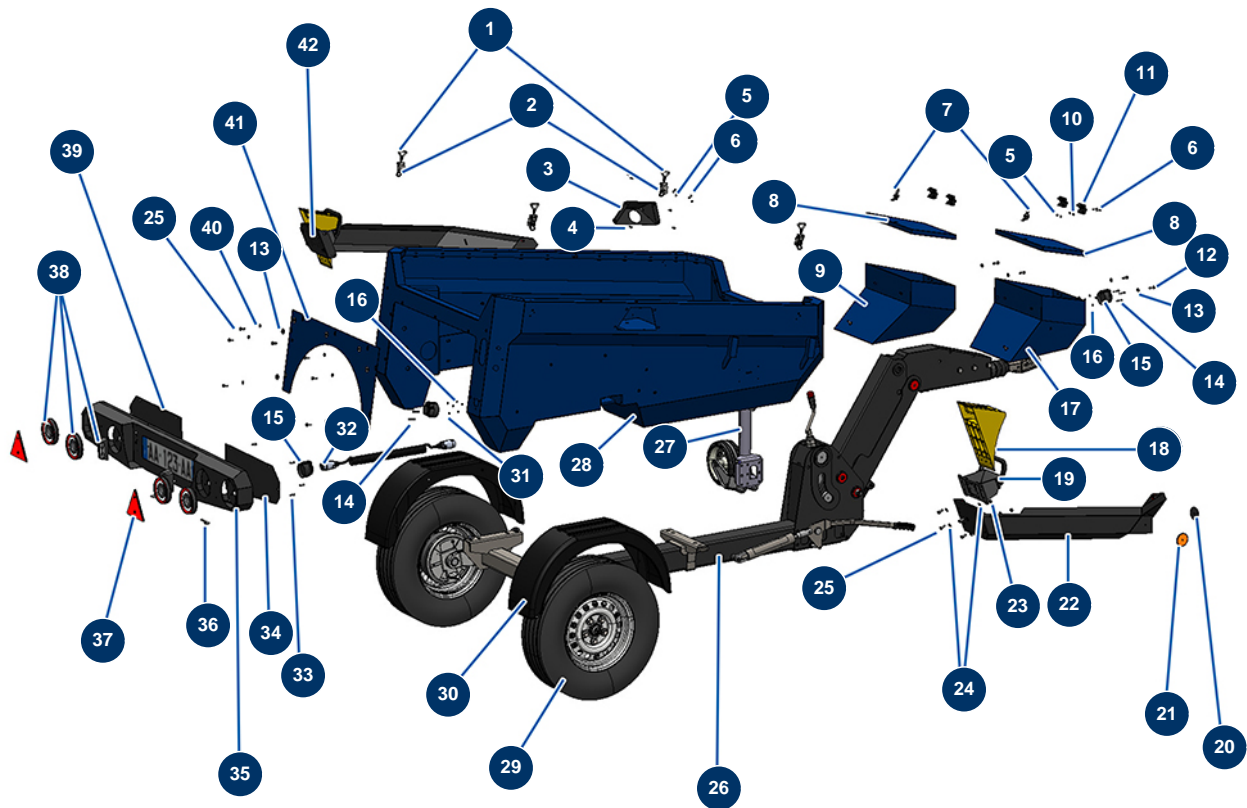

Détails des pièces

Pos.	Référence	Désignation
1	15021	Adjustable toggle without hook
2	15022	Adjustable toggle locking hook
3	C23221	3
4	11145	6 x 16 inox cylindrical pan head screw
5	11880	M 5 nylstop nut
6	12135	6
7	13035	7
8	C23171	8
9	C23237	9
10	30290	ø 5 large washer
11	36036	11
12	11544	THEF 8 x 25 screw
13	30292	ø 8 inox large washer

Pos.	Référence	Désignation
14	20375	14
15	14913	Lighting metal 7-pin female socket - C.P 60
16	70086	M 5 nylstop inox nut
17	C23170	17
18	20213	X-PRO D140 yellow plastic wheel chock
19	20214	X-PRO black wheel chock holder
20	12362	Round & white reflector - C.P 60
21	12361	Round & orange reflector - C.P 60
22	C23180	22
23	90127	M 8 nylstop nut
24	30256	ø 8 inox narrow washer
25	30273	THEF 8 x 20 screw
26	30280	ø 10 inox narrow washer
27	14171	
28	C23154	28
29	30279	29
30	20212	X-PRO D200 & X-SCREED plastic mudguard
31	70085	ø 5 narrow washer
32	14912	
33	20363	33
34	C23266	34
35	C23158	35
36	20046	4 mm R pin
37	12360	Triangular red reflector
38	20601	38
39	C23159	39
40	80269	Grower washer ø 8
41	C30001	41
42	C23179	42