

TWINMIX two-component dosing machine - Chassis

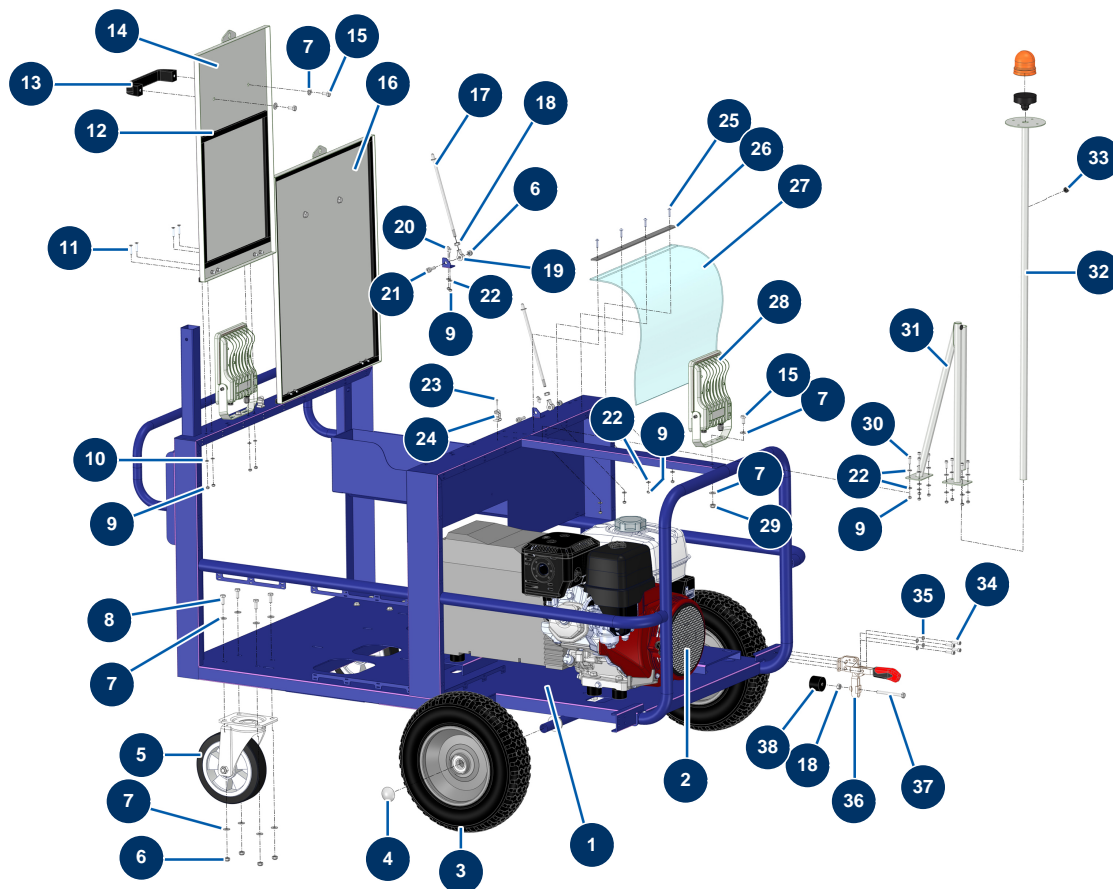

Détails des pièces

Pos.	Référence	Désignation
1	C24024	1
2	14936	Petrol motor HONDA GX 390UT2-QN-R2-0H, electric start, 18 A
3	80351	Complete Ø400 wheel with bearing - axle of 25
4	90282	Ø25 chromed clip
5	MI3F00300902	Pivot wheel without brake
6	90127	M 8 nylstop nut
7	80260	ø 8 inox medium washer
8	30273	THEF 8 x 20 screw
9	11880	M 5 nylstop nut
10	70085	ø 5 narrow washer
11	12121	5 x 25 countersunk head screw
12		12
13	1042523	CP 60 grid handle

Pos.	Référence	Désignation
14	C24031	14
15	30295	THEF 8 x 16 screw
16	C24033	16
17	C24060	17
18	14075	M 8 inox nut
19	13240	
20	15097	5 x 10 inox cylindrical pan head screw
21	12783	8 x 25 cylindrical head screw
22	11737	∅ 5 inox medium washer
23	12232	∅ 3,2 x 11 POP rivet
24	80585	
25	20290	5 x 20 10.9 cylindrical head screw
26	C24110	26
27	MI4920001010	MIXPRO 28 compressor protection plastic
28	15341	
29	13980	M 8 nylstop inox nut
30	90160	5 x 16 cylindrical head screw
31	C24043	31
32		32
33	13399	∅6 rubber grommet
34	90996	6 x 20 inox cylindrical head screw
35	70087	∅ 6 inox narrow washer
36	12142	MIXPRO 100 product trapdoor locking clamp
37	14930	THEF 8 x 80 screw
38	13963	∅40 x 30 stop - M8 inner thread