

## X-PRO D60 spraying machine - Hydraulic (supply)

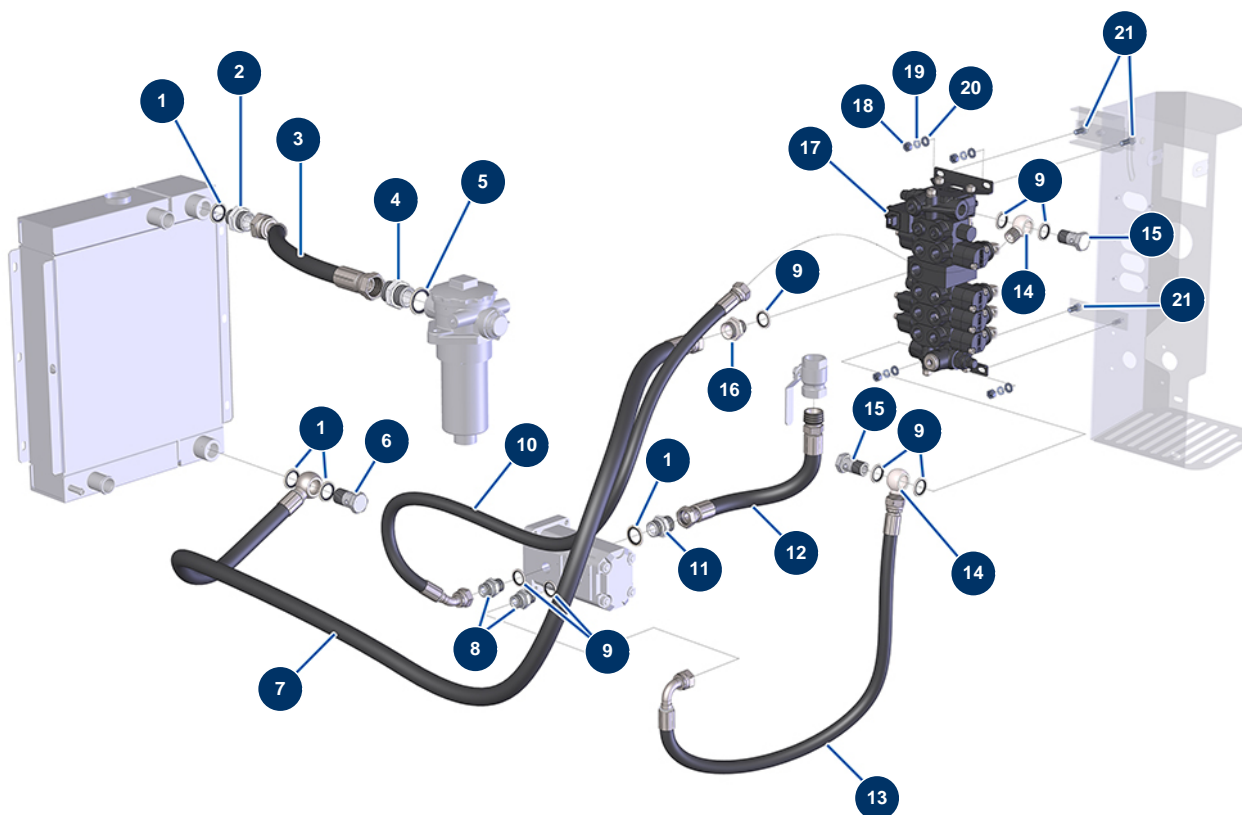

### Détails des pièces

Pos.	Référence	Désignation
1	12573	Steel gasket for 3/4" hollow screw with lip
2	12569	3/4" MaleD x 1" MaleD high-pressure nipple
3	14523A	Flexible hose 240 - BONDIOLI radiator return/hydraulic tank - C.P 60 2018
4	12568	1" MaleD x 1" MaleD high-pressure nipple
5	12572	Steel gasket for 1" hollow screw with lip
6	13307	3/4 HP drilled head screw
7	13305A	Flexible hose 220 - distributor/oil cooler - CP 60
8	90627	1/2" MaleD x 1/2" MaleD high-pressure nipple
9	91032	Steel gasket for hollow screw with 1/2" lip
10	13075	Flexible hose 215 - hopper circuit supply - CP 60
11	90774	3/4" MaleD x 3/4" MaleD high-pressure nipple
12	13071A	Flexible hose 211 - hydraulic tank supply - CP 60
13	13074	Flexible hose 214 - mixer circuit supply - CP 60

Pos.	Référence	Désignation
14	12571	1/2" banjo threaded 1/2"
15	13285	1/2 drilled head screw ø 21
16	12733	1/2" MaleD x 3/4" MaleD high-pressure nipple
17	12332	5-way distributor with LP and integrated hopper Bypass - C.P 60
18	90440	M 8 zinc plated nut
19	80269	Grower washer ø 8
20	30256	ø 8 inox narrow washer
21	30273	THEF 8 x 20 screw